

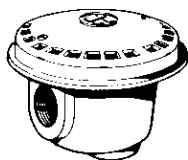

N1083



N1085



N1146

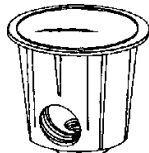

N1146

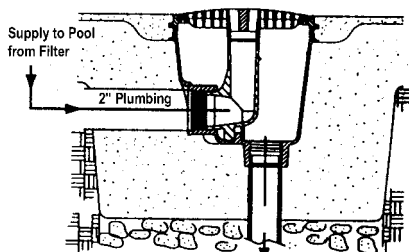

N1076

1-1/2" Return to Pump Suction

MAIN DRAINS - Round

| | | ITEM NO. |
|--|------------------|----------|
| 1-1/2" Main Drain (7-3/4" Grate) | SP1053AV (2-pak) | N1070 |
| <i>1-1/2" Side x 2" Bottom</i> | | |
| 1-1/2" Main Drain (7-3/4" Grate) | SP1153AV (2-pak) | N1083 |
| <i>Anti-Vortex 1-1/2" Side x 2" Bottom</i> | | |
| 1-1/2" Main Drain (7-3/4" Grate) | SP1051AV (2-pak) | N1085 |
| <i>Anti-Vortex 1-1/2" Side x 1-1/2" Bottom</i> | | |
| 1-1/2" Main Drain (Jacuzzi) | MD-G15-GRT (ea) | N1146 |
| <i>1-1/2" Side x 1-1/2" Bottom</i> | | |
| 1-1/2" Main Drain (Jacuzzi) | MD-G15-AV (ea) | N1060 |
| <i>Anti-Vortex 1-1/2" Side x 1-1/2" Bottom</i> | | |
| 1-1/2" Main Drain (Pentair) | 542031 (ea) | N1209 |
| <i>Anti-Vortex 1-1/2" 2" Ports on the Bottom</i> | | |
| 2" Main Drain (7-3/4" Grate) | SP1054AV (2-pak) | N1099 |
| <i>Anti-Vortex 2" Side x 2" Bottom</i> | | |
| 2" Main Drain (7-3/4" Grate) | SP1154AV (2-pak) | N1082 |
| <i>A.V. w/Adjustable Collar 2" Side & Bottom</i> | | |
| 2" Main Drain (7-7/8" Grate) | SP1052AV (2-pak) | N1078 |
| <i>2" Side x 1-1/2" Bottom</i> | | |
| 2" Main Drain (Jacuzzi) | MD-G2-AV (ea) | N1143 |
| <i>2" Side x 1-1/2" Bottom</i> | | |
| 2" Swimquip Main Drain Sump | 07017-0103 (ea) | N1104 |
| <i>2" Side x 1-1/2" Bottom</i> | | |
| Frame & Grate (8" A.V.) | 07017-0741 (ea) | N1086 |
| <i>(8" Anti-Vortex - Swimquip)</i> | | |

MAIN DRAIN BUMPER

| | |
|---|-------|
| Hayward Main Drain Bumper | N1425 |
| <i>Fits Hayward A.V. Drains to Keep Cleaners off the Main Drain</i> | |

MAIN DRAINS - Black

| | | |
|---|---------|-------|
| Black Main Drain (7-7/8" Grate) | 54-2041 | N1084 |
| <i>Anti-Vortex 1-1/2" I.D. x 2" O.D. Slip</i> | | |

MAIN DRAINS - Gray

| | | |
|---|------------|-------|
| Gray Main Drain Sump Only | 07017-1103 | N1103 |
| <i>No Grate (Swimquip) 2" Side, 1-1/2" Bottom</i> | | |
| Gray Frame & Grate (8" A.V.) | 07017-1741 | N1114 |
| <i>(8" Anti-Vortex - Swimquip)</i> | | |

MAIN DRAINS- Liner Pools

| | | |
|---|------------------|-------|
| White Main Drain 1-1/2" Anti-Vortex | SP1048AV (2-pak) | L4095 |
| White Main Drain 2" Anti-Vortex | SP1049AV(2-pak) | L4092 |
| White Main Drain - 1-1/2" Anti-Vortex Jacuzzi | (ea) | L4097 |
| White Main Drain - 2" Anti-Vortex Jacuzzi | (ea) | L4091 |

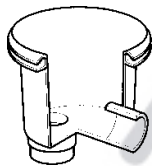

SWIMQUIP

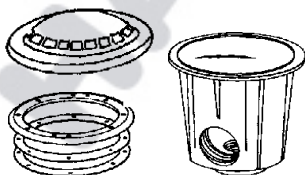

JACUZZI



MAIN DRAIN ACCESSORY KIT

Reduces risk of entrapment or evisceration from suction

Hayward Main Drain Accessory Kit SP1048RKIT

*For use w/ most new or existing Hayward round main drains

ITEM NO.
N1095

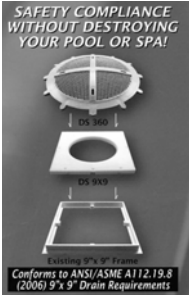

N1211



ANTI-HAIR SNARE PLUS

Anti-Hair Snare Drain Assembly
w/ mud ring/cover/screws

White
Gray
Black



N1162
N1212
N1214
N1201
N1167
N1211

Star 100 Main Drain Cover
Universal Frame/Adapter (for Swimquip)

Drain Safe Frame and Grate, one size fits most main drains up to 9" x 9"

*One size fits all. Helps eliminates hair entanglement & child evisceration. Minimizes entrapment
Screws available on page 169*



N1120



N1150

COLLECTOR TUBE

Collector Tube for Main Drain - 1-1/2" & 2"

N1120

HYDROSTATIC RELIEF VALVES

Hydrostatic Relief Valve, ABS - 1-1/2" & 2"
Astral Hydrostatic Relief Valve, ABS - 1-1/2"
American Hydrostatic Relief Valve, ABS - 1-1/2"
Hydrostatic Relief Valve, Brass - 1-1/2"

N1150
N1150A
N1530
N1155

Tool for ABS Hydrostat Removal SP1056T

N1156

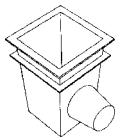

SUMPS FOR MAIN DRAINS

3" Main Drain Sump for 9" x 9" Frame & Grate
4" Main Drain Sump for 12" x 12" Frame & Grate
6" Main Drain Sump for 12" x 12" Frame & Grate
8" Main Drain Sump for 18" x 18" Frame & Grate

N1121
N1091
N1089
N1097

SQUARE FRAMES & GRATES



| | | | |
|-----------|---------------------|------------------------------|-------|
| 7-3/4" | Round Frame & Grate | Anti-Vortex | N1111 |
| 9" x 9" | Frame & Grate | Plastic (3/4" Thick) | N1170 |
| 9" x 9" | Frame & Grate | Plastic Black | N5150 |
| 12" x 12" | Frame Only | Plastic (1" Thick) | N1132 |
| 12" x 12" | Frame & Grate | Plastic (3/4" Thick) | N1128 |
| 12" x 12" | Frame & Grate | Plastic (1" Thick 2-pak) | N1125 |
| 12" x 12" | Frame & Grate | Plastic Anti-Vortex | N1124 |
| 12" x 12" | Frame & Grate | Plastic Black | N5152 |
| 12" x 12" | Frame & Grate | Chrome | N1135 |
| 18" x 18" | Frame Only | Plastic Hayward | N1186 |
| 18" x 18" | Frame & Grate | Plastic Pentair (3/4" Thick) | N1126 |
| 18" x 18" | Frame & Grate | Plastic Hayward | N1123 |

REPLACEMENT GRATES (Square)

| | | | |
|-----------|------------|----------------------|-------|
| 9" x 9" | Grate Only | White (3/4" Thick) | N1177 |
| 9" x 9" | Grate Only | White (1" Thick) | N1176 |
| 9" x 9" | Grate Only | Black | N1163 |
| 12" x 12" | Grate Only | Plastic (3/4" Thick) | N1129 |
| 12" x 12" | Grate Only | Plastic (1" Thick) | N1130 |
| 12" x 12" | Grate Only | White Anti-Vortex | N1127 |
| 12" x 12" | Grate Only | Black | N1164 |
| 12" x 12" | Grate Only | Chrome | N1134 |

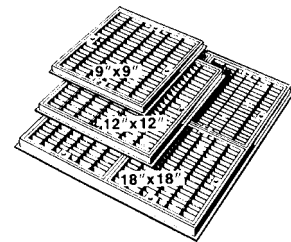

PacFab/Seablue Style
3/4" M.D. Frame & Grates

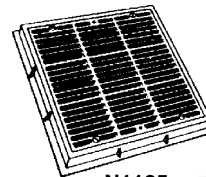

N1125

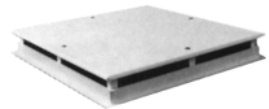

N1124

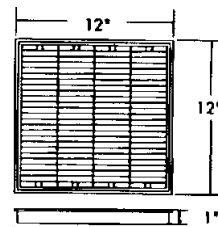

N1130

REPLACEMENT GRATES (Round)

For liability purposes, we strongly recommend conversion of all types of round main drain grates (flat & anti-vortex) to "Anti-Hair Snare Plus" on page 196. One size fits all (adapter needed for (Sta-Rite/Swimquip brand). Screws listed down below.

| | | ITEM NO. |
|--|----------------|----------|
| American A.V. Plate | 871024 | L2039 |
| Anthony Flat Grate - White | ABF-51-W-CO | N1112 |
| Anthony Anti-Vortex - White | ABF-64-W-CO | N1113 |
| Anthony Frame & Grate A.V. | ABF-64-W | N1111 |
| 4-1/8" Flat Grate - Chrome | Sylvan | N1094 |
| 5-3/8" Flat Grate - White | Sylvan | Z5034 |
| 6" Anti-Vortex Grate - White | Sylvan | Z5035 |
| 6-1/2" Jacuzzi A.V. - White | 43-1024-09R | N1087 |
| 7-3/4" A.V. Grate - White | SP1048E | N1456 |
| 7-3/4" A.V. Grate - Black | SP1048EBLK | N1410 |
| 7-3/4" A.V. Grate - Black | SP1048E-BLK | N1410 |
| 7-3/4" A.V. Frame & Grate | SP1030AV-2 Pak | N1034 |
| 7-3/4" A.V. Frame & Grate - Black | - Black | N1101 |
| 7-11/16" Sta-Rite Frame & AV plate - Black | | N1107+ |
| 8" Swimquip A.V. Frame & Grate - White | | N1086 |
| 8" Swimquip A.V. Frame & Grate - Gray | | N1114 |
| 8" Pentair A.V. Main Drain & Grate - Black | | N1080 |
| Waterway A.V. Frame & Grate - Gray | 640-2317 | N1223 |
| Waterway A.V. Frame & Grate- D. Gray | 640-2319 | N1225 |
| Waterway A.V. Frame & Grate- Black | 640-2311 | N1227 |

+Limited Stock

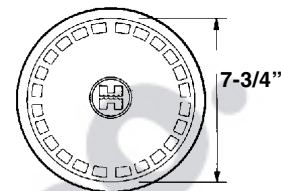

N1456

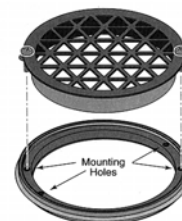

Swimquip
M.D. Grate

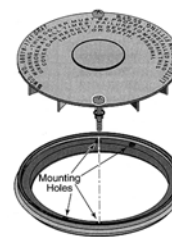

Swimquip
Anti-Vortex Grate



MAIN DRAIN SCREWS

American

| | | ITEM NO. |
|--|----------|----------|
| Sealing Screw #13-16 x 1-1/4" for Concrete & Liner Anti-Vortex | 98207200 | L4928 |
| Sealing Screw #13-16 x 1" for Concrete & Liner Regular | 98202900 | L4929 |

Anti-Hair Snare

| | | |
|---|---------|---------|
| Grate Screw (Set of 6) Fits Sta-Rite/Swimquip Main Drains | SCR-006 | N1167S* |
| Grate Screw (Set of 14) Fits Hayward, Pentair & others | SCR-014 | N1162S* |

Hayward

| | | ITEM NO. |
|---|---------------|----------|
| Grate Screw - Nylon for SP1031 (9x9), 1032 (12x12) & 1033 (18x18) | SPX1031-Z-1 | N1188 |
| Grate Screw (Set of 2) for SP1030AV (Medium) | SPX1039-Z-1-D | N1413 |
| Grate Screw (Set of 2) for SP-1048-C (Short) | SPX1425-Z-3-2 | N1420 |
| Grate Screw (Set of 2) for SP1051 & SP1154 (Long) | SPX1030-Z-1A | N1459 |
| Grate Screw (Set of 2) for SP1048 & SP1049AV (Liner - Extra Long) | SPX1030-Z-2A | N1460 |
| Frame Screw (Set of 8) for SP1048 & SP1049 | SPX1039-Z-1-8 | N1454 |

*Non-Stock Item

Pentair (PacFab)

| | | |
|---|---------|--------|
| Grate Screw - Flat Phillips #12 x 1" for Gunitite & Vinyl | 55-2472 | H3253 |
| Grate Screw - Flathead #10 x 3/4" for Regular Cover | 55-2473 | L4093+ |

Sylvan

| | | |
|-----------------------------|--|-------|
| Screw for Anti-Vortex Cover | | Z5039 |
|-----------------------------|--|-------|

Anthony

| | | |
|-----------------------|--|-------|
| Light Face Ring Screw | | Z7036 |
|-----------------------|--|-------|

+Limited Stock